

GEMCOM MODEL SH-004 CUSTOM GRAPHIC ANNUNCIATOR

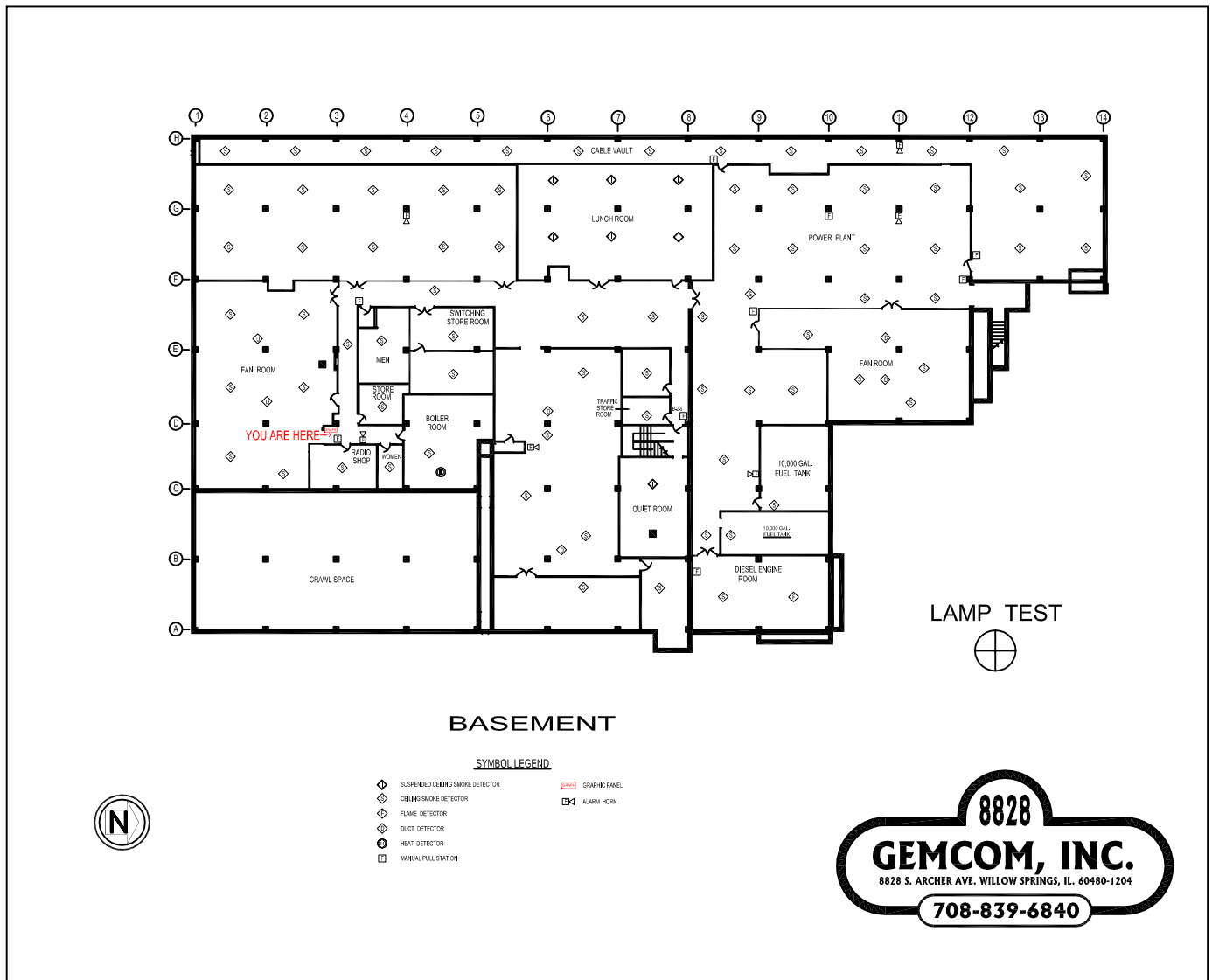

8828
GEMCOM, INC.
8828 S. ARCHER AVE., WILLOW SPRINGS, IL. 60480-1204
708-839-6840

SYSTEM APPLICATIONS FOR BUILDING FIRE ALARM, CLEAN AGENTS, CO2, PREACTION, SPRINKLERS, FAN CONTROLS, AND INDUSTRIAL CONTROL MONITORING

- PROVIDES FOR UP TO 640 LEDS PER ANNUNCIATOR
MAXIMUM NUMBER OF LEDS DEPENDS ON DRAWING REQUIREMENTS
- 20" X 32" DIRECTORY TEXT AREA
VERTICAL MOUNTING WITH LEFTHAND HINGE STANDARD, RIGHTHAND HINGE, AND HORIZONTAL MOUNTING WITH BOTTOM HINGE AVAILABLE WITH FLUSH TRIM RING
- 3 LED COLORS AVAILABLE FOR CODING
RED, YELLOW, AND GREEN 2mA LEDS WITH A 50 DEGREE FIELD OF VISION. OTHER COLORS AVAILABLE UPON REQUEST.
- HIGH QUALITY ARTWORK PLOTTED ON 4 MIL HIGH QUALITY MYLAR
COMPUTER AIDED DRAFTING ALLOWS FOR EFFICIENT ART WORK MODIFICATIONS
- MULTI-COLOR BACKGROUND AVAILABLE
MULTICOLOR ARTWORK IS ALSO AVAILABLE
- INSTALLATION IS EFFICIENT
DETAILED WIRING DIAGRAMS ARE PROVIDED WITH EACH ANNUNCIATOR
- REVISIONS TO ART WORK ARE POSSIBLE
NOT NECESSARY TO REBUILD ENTIRE GRAPHIC FOR MOST FUTURE REVISIONS
- U.L. AND C.S.F.M. LISTING AVAILABLE